

4

3

2

1

NOTES: UNLESS OTHERWISE SPECIFIED
1. INTERPRET DRAWING IN ACCORDANCE WITH ASME Y14.5-1994.

- 2 MATERIAL: C26000 BRASS, 1/2 HARD.
- 3 FINISH: POST-PLATED .000120"-.000200" [0.0030-0.0050] TIN (LEAD FREE) OVER .000050"[0.0010] MIN NICKEL.
- 4 ALL DIMENSIONS APPLY AFTER PLATING.
- 5 .004[0.10] MAX BLANKING BURR PERMISSIBLE. BURRS MUST NOT EXCEED THE SPECIFIED FEATURE TOLERANCE. .001[0.03] BURRS, IN DIE DIRECTION, WHERE NOTED.
- 6 .005[0.13] MAX RADII & FILLETS PERMISSIBLE ON ALL CORNERS.
- 7 PART TO BE SUPPLIED ON A CONTINUOUS REEL AS SHOWN; ONE BREAK AND NO SPLICES ALLOWED. QTY OF PARTS PER REEL: ±15% SEE TABLE. PACKAGE PER AUTOSPlice SPEC 0049, EXCEPT ADD FOAM CORNERS (4x) IN BOX.
- 8 SOLDERABILITY PER MIL-STD-202 METHOD 208.
- 9 OPTIONAL LEG STAMPING. SEE DETAIL B-B.

10. RECOMMENDED HOLE SIZES:
- a) - HOLE SIZE: DRILL $\phi .056 \pm .001$ [$\phi 1.42 \pm 0.03$]
.0007-.0010 [0.018-0.025] THK Cu: $\phi .054 \pm .002$ [$\phi 1.37 \pm 0.05$]
 - b) - HOLE SIZE: DRILL $\phi .059 \pm .001$ [$\phi 1.50 \pm 0.03$]
.002-.003 [0.05-0.08] THK Cu: $\phi .054 \pm .002$ [$\phi 1.37 \pm 0.05$]
 - c) - HOLE SIZE: DRILL $\phi .059 \pm .001$ [$\phi 1.50 \pm 0.03$]
.002-.003 [0.05-0.08] THK Cu: $\phi .054 \pm .002$ [$\phi 1.37 \pm 0.05$]
FINISHED TIN/LEAD HOLE: $\phi .053 \pm .002$ [$\phi 1.35 \pm 0.05$]
- FOR a), b) and c): CENTER TO CENTER: $.200 \pm .002$ [5.08 ± 0.05]

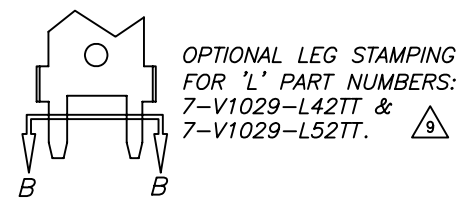
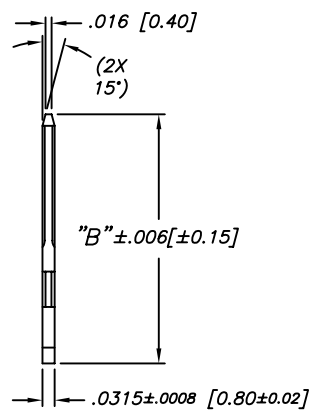
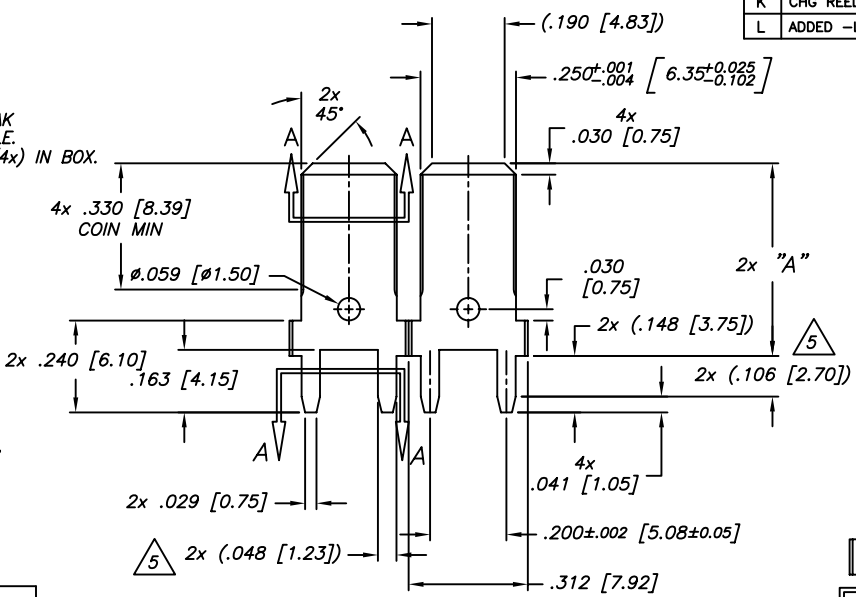
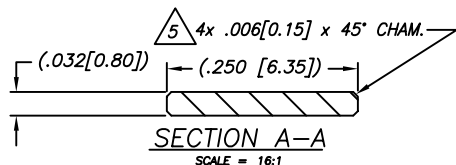

P/N	A	B	QTY / REEL	UNWINDING DIRECTION
7-V1029-062TT	.886[22.50]	1.034[26.26]	6,500	1
7-V1029-152TT	.762[19.35]	.909[23.10]	7,000	2
7-V1029-052TT	.762[19.35]	.909[23.10]	7,000	1
7-V1029-L52TT ⁹	.762[19.35]	.909[23.10]	7,000	1
7-V1029-042TT	.671[17.05]	.819[20.80]	8,000	2
7-V1029-L42TT ⁹	.671[17.05]	.819[20.80]	8,000	2
7-V1029-002TT	.504[12.80]	.652[16.55]	9,000	1

PART No. TABLE

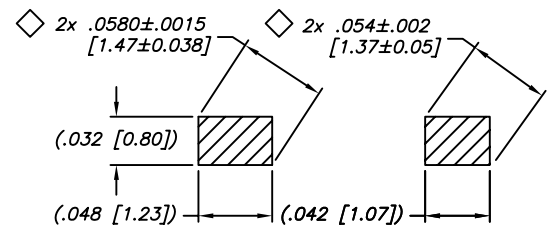
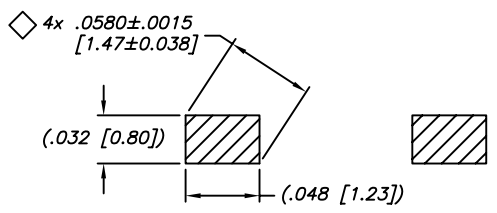
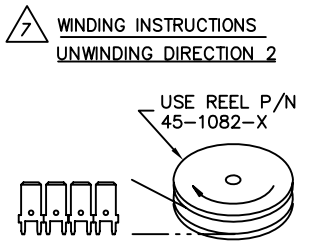
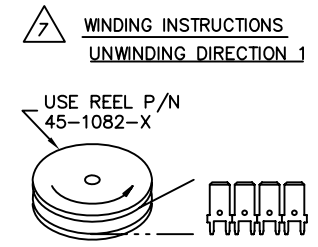

CUSTOMER DRAWING

This drawing and the information set forth hereon are the property of Autossplice, Inc. and are to be held in trust and confidence. Publication, duplication, disclosure, or use for any purpose not expressly authorized in writing by Autossplice, Inc. is prohibited.

MATERIAL ²
FINISH ³

TOLERANCES UNLESS OTHERWISE SPECIFIED DIM IN INCHES		AUTOSPlice INC. 10121 Barnes Canyon Road San Diego, California 92121 (658) 535-0077	
DECIMAL: XX ± .01	[X.X] ± [0.3]	THIRD ANGLE PROJECTION	DRAWN BY MacKay DATE 03-27-00
[.XX] ± .004	[X.XX] ± [0.10]	ENGINEERED BY JB	DATE 03-27-00
ANGULAR: ± 3°		TITLE VERTICAL TERMINAL, .250	
◇ DENOTES SPECIAL CHARACTERISTIC		SIZE C	FORM NO. QAE89
		DRAWING NUMBER C7-V1029-[] [] 2TT	REVISION L
		SCALE: 4:1	CAD FILE NO. C7-V1029-[] [] 2TTL.DWG SHEET 1 OF 1

REV	REVISION RECORD	ECN	BY	APVD	DATE
D	ADD QTY PER REEL	502007	JB	JB	02-22-02
E	CHNG COIN .295 to .330	502209	JB	JB	06-26-02
F	NEW RELEASE ITEM -062	502011	JB	JB	07-09-02
G	REVISED PER EWR 104074	503500	BILL	JB	08-17-04
H	NEW REL ITEMS-052TT &-042TT	504103	BILL	PVB	09-15-05
J	ADDED P/N 7-V1029-152TT	504350	BILL	PVB	1-31-05
K	CHG REEL DIR OF -042 PER EWR 105145	504665	RJB	RJB	8-06-06
L	ADDED -L42 & -L52 PER EWR 106260	505609	RJB	RJB	1-03-09

4

3

2

1