

REV	REVISION RECORD	ECN	BY	APVD	DATE
A	INITIAL RELEASE	507066	JH	JH	05/28/15

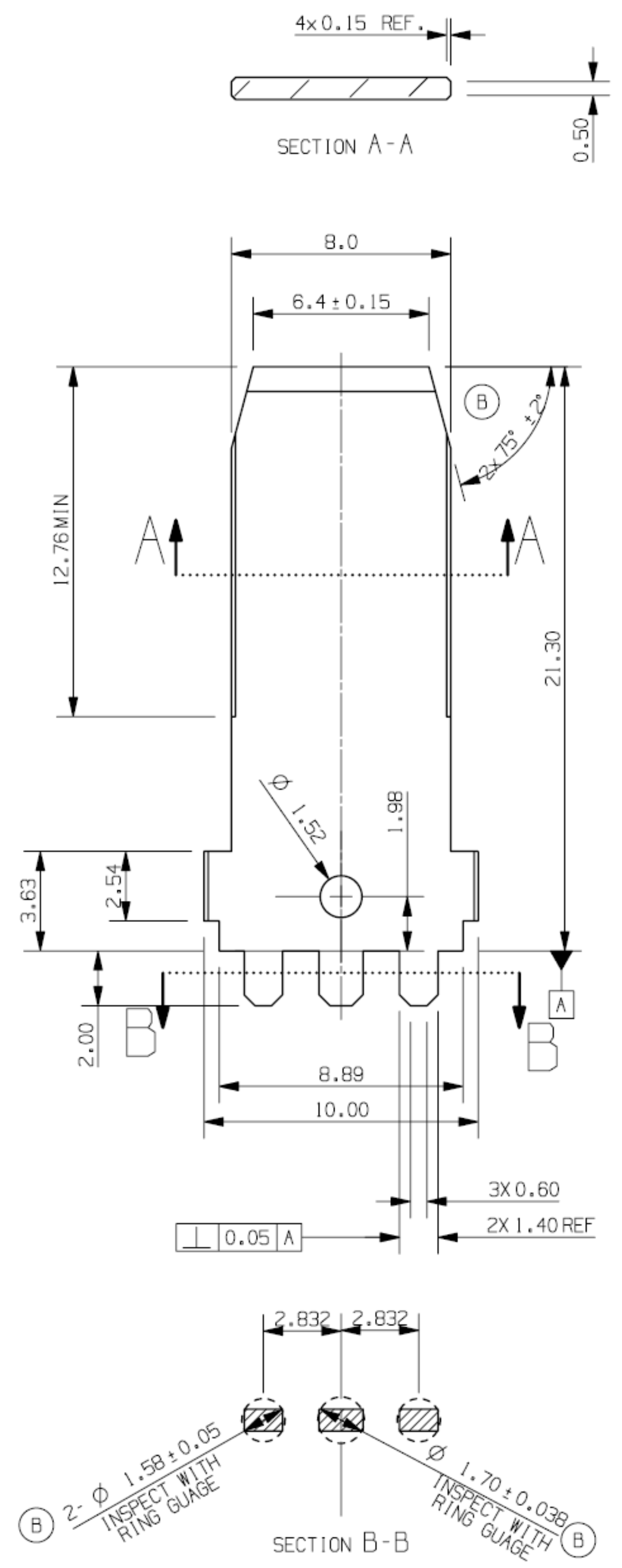

- NOTES:
- MATERIAL: C21000, FULL HARD
  - FINISH: PLATED TIN (LEAD FREE) 0.0008-0.0015 THICK, OVER 0.001 NI
  - BLANKING BURRS MUST NOT EXCEED 0.1MM MAX; & MUST NOT EXCEED THE SPECIFIED ARE BURRS SHOULD NOT EXCEED 0.03MM.
  - 0.13 MAX RADIUS & FILLETS PERMISSIBLE ON ALL CORNERS.
  - ALL DIMENSIONS APPLY AFTER PLATING.
  - SOLDERABILITY PER IPC/EIA/JDEC J-STD-002, TEST A, CATEGORY 3.

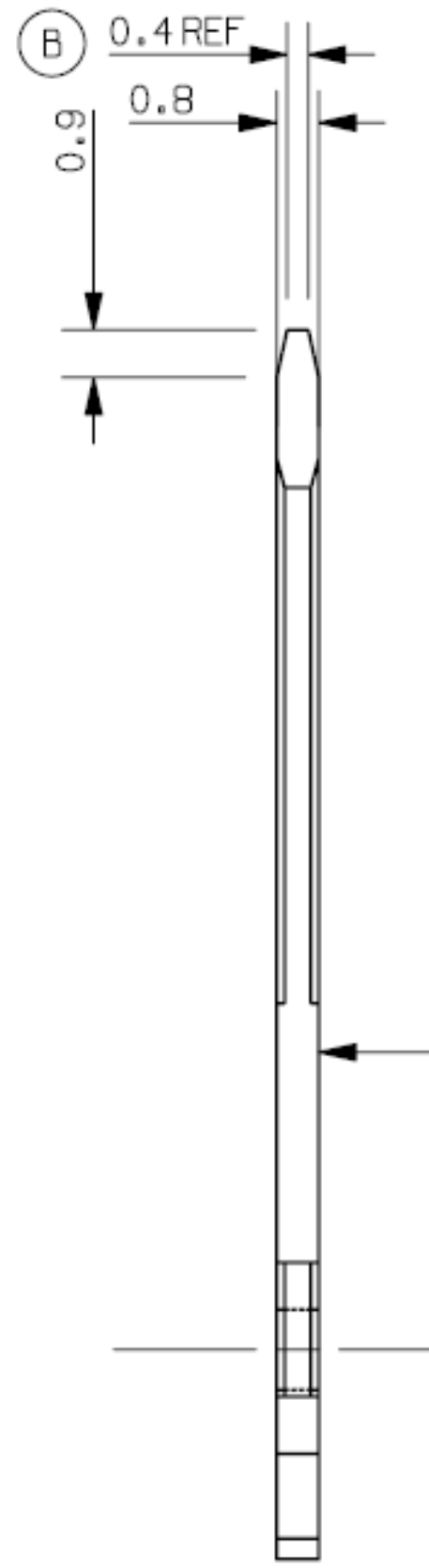

METRIC COMPONENT

NO	COMPONENT NO	DESCRIPTION	QTY/M	U/M
BILL OF MATERIAL				
UNLESS OTHERWISE SPECIFIED, DIMENSIONS ARE IN MILLIMETERS. DIMENSIONS IN BRACKETS [ ] ARE INCHES				
UNLESS OTHERWISE SPECIFIED, DIMENSIONS DO NOT INCLUDE PLATING.				
$\odot$	DENOTES CRITICAL CHARACTERISTICS.			
CPK	DENOTES CPK DIMENSIONS, -MINIMUM CPK VALUE			
ST	DENOTES A CHARACTERISTIC THAT PROVIDES AN INDICATION OF PROCESS PERFORMANCE. PROCEDURE FOR MEASUREMENT AND TRACKING TO BE DEFINED IN LITTELFUSE INSPECTION INSTRUCTIONS			
CP	DENOTES CP DIMENSIONS, -MINIMUM CP VALUE MUST BE WITHIN THE DIMENSIONAL LIMITATIONS SHOWN ON DRAWING AND INITIALLY LOCATED TO ALLOW FOR MAXIMUM TOOL LIFE			

COPIES TO	MATL SPEC	SEE NOTES
1 9	FINISH	SEE NOTES
2 10	DRW	DATE 06/24/14
3 12	EJIN	SCALE 1:1
4 13	CHK	DATE
5 14	APPD	DATE
6 15	FINISH GOOD WT	GRAMS/PIECE
7 16	TOLERANCES UNLESS OTHERWISE SPECIFIED (REF. 150 2769-FH)	
8 17	DIMENSION	
9 18	TOLERANCE	
10 19	3RD ANGLE PROJECTION	
11 20	TITLE	
12 21	800 BLADE TERMINAL	
13 22	REVISION DRWG. NO.	
14 23	B 875-582	
15 24	Littelfuse	
16 25	DES PLAINES, ILLINOIS 60016	

LTR	DATE	REVISION	CHK	APD
A	06/24/14	ERAS10652 NEW RELEASED EJIN		
B	04/17/15	ERAS11798 UPDATE ACCORDING TO SUPPLIER'S REQUEST: 75° $\pm$ 2° MS45° $\pm$ 1.0, 0.08 MS $\pm$ 0.05; $\phi$ 1.58 $\pm$ 0.05 MS $\phi$ 1.82; 0.9 MS 0.7 EJIN		

CONFIDENTIAL SALES DRAWING

SOLID EDGE HOME USE

autosplice 10431 Wateridge Circle, Suite 110 San Diego, CA 92121-5703 619-535-0027

TERMINAL, BLADE 8.00 x 0.81

DATE: 5/28/15

ENGINEERED BY: JH

SCALE: 2:1

ITEM NUMBER: C230

SIZE: D

PSKCH NO: OAE89

ISSUING NUMBER: C7-V1125-002TT

REVISION: A

SCALE: 2:1

DATE: 5/28/15

NO. OF SHEETS: 1

SHEET: 1 OF 1