

REV	REVISION RECORD	ECN	BY	APVD	DATE
A	INITIAL RELEASE PER EWR 980598	16044	CD	JB	1-13-89
B	UPDATE PER COMP. ENG.	502865	RJB	RJB	8-15-03

NOTE: UNLESS OTHERWISE SPECIFIED

1. INTERPRET DRAWING IN ACCORDANCE WITH ANSI Y14.5-1982.
2. ALL DIMENSIONS APPLY AFTER PLATING.
3. PITCH CONSISTENCY TO BE WITHIN ± 0.005 WHEN THE OAL OF 5 STRIPS, (3.00") LONG ARE MEASURED.

A PART TO BE SUPPLIED ON A CONTINUOUS REEL

PART NUMBER BREAKDOWN

0 = UNDER 1 INCH OAL
1 = OVER 1 INCH OAL.

PIN SIZE

8-62C

PIN TYPE
(SEE SECTION A-A)

C ROUND KNURLED

OVERALL LENGTH "L"

PIN LENGTH "P"
ABOVE COIN

FINISH VARIATIONS

MATERIAL

- 1** = C10200 COPPER ALLOY, FULL HARD
- 2** = C26000 BRASS, 3/4 HARD
- 5** = C51000 PHOSPHOR BRONZE, 3/4 HARD
- 7** = C72500 COPPER/NICKEL/TIN ALLOY

- AA** = TIN/LEAD .000120 MIN OVER NICKEL
- BB** = GOLD PLATE .000005 OVER NICKEL
- CC** = GOLD PLATE .000010 OVER NICKEL
- WW** = GOLD PLATE .000015 OVER NICKEL
- DD** = GOLD PLATE .000020 OVER NICKEL
- EE** = GOLD PLATE .000030 OVER NICKEL
- NN** = NICKEL PLATE .000050
- FF** = Au .000003 OVER Pd-Ni .000012 OVER Ni
- RR** = UNPLATED

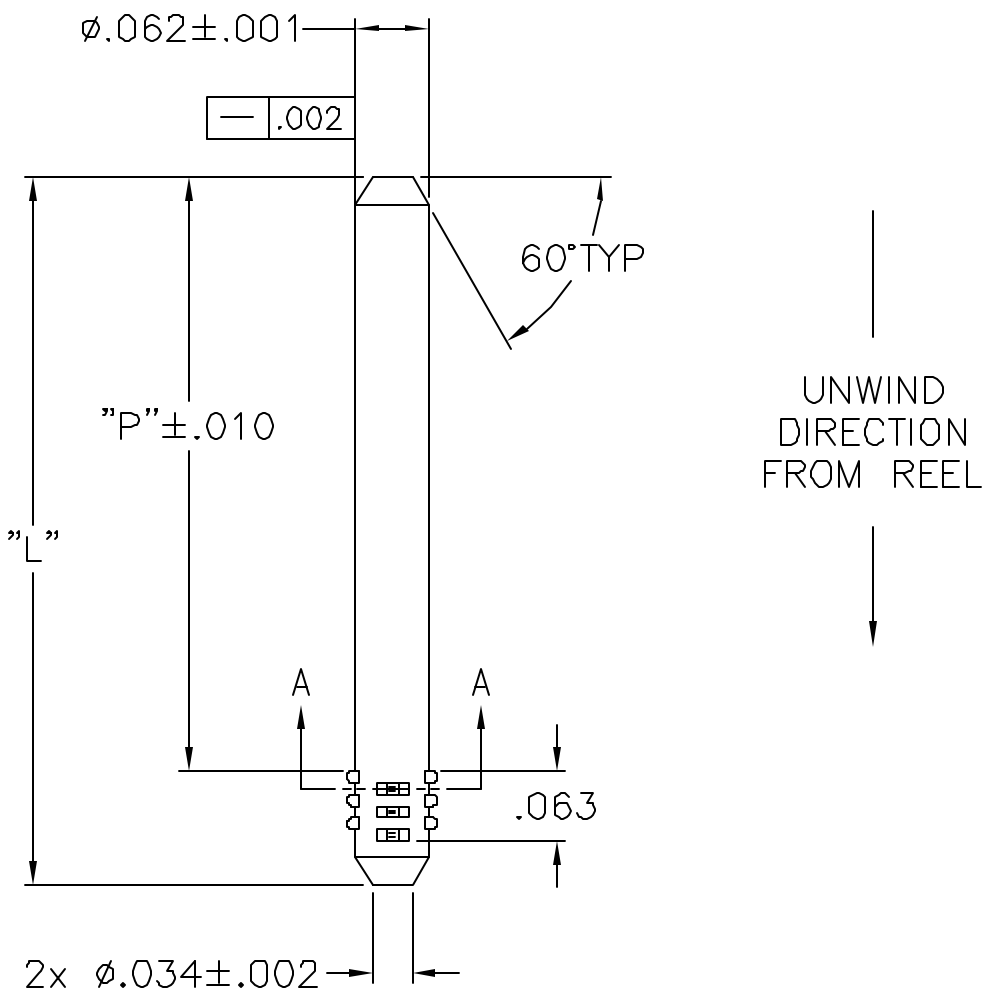

A REELING ORIENTATION
AP/2 REEL
(24" O.D. x 20" I.D.)

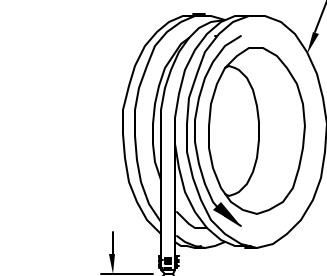

REELING ORIENTATION

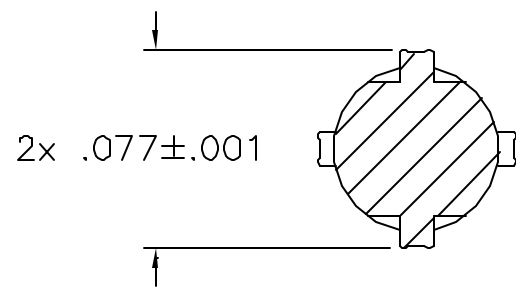

SECTION A-A

CUSTOMER DRAWING

This drawing and the information set forth herein are the property of Autossplice, Inc. and are to be held in trust and confidence. Publication, duplication, disclosure, or use for any purpose not expressly authorized in writing by Autossplice, Inc. is prohibited.

TOLERANCES UNLESS OTHERWISE SPECIFIED DIMS IN INCHES		DECIMAL: XX = $\pm .01$		XXX = $\pm .005$		ANGULAR: $\pm 3'$	
				AUTOSPLICE INC. 10121 Barnes Canyon Road San Diego, California 92121 (619) 636-0077		DRAWN BY C. DANG DATE 1-04-99 APPROVED BY BIANCA DATE 1-05-99	
TITLE AUTOPIN/2 DETAIL PART DRAWING							
SIZE C	PSGM NO. 0AE89	DRAWING NUMBER C8-62C	REV. B		SHEET 1 OF 1		