

4

3

2

1

NOTES: (UNLESS OTHERWISE SPECIFIED)

- 1. INTERPRET DRAWING IN ACCORDANCE WITH ASME Y14.5-1994.
 - 2. MATERIAL: BRASS C26000, 1/2 HARD.
 - 3. FINISH: POST- PLATE .000200"- .000300" MATTE TIN (LEAD FREE) OVER .000050"- .000100" NICKEL.
 - 4. ALL DIMENSIONS APPLY AFTER PLATING.
 - 5. .003 MAX BLANKING BURR PERMISSIBLE, BURRS NOT TO EXCEED THE SPECIFIED FEATURE TOLERANCE.
 - 6. .001 MAX BURR ALLOWED THIS SIDE.
 - 7. .005 MAX RADII PERMISSIBLE ON ALL CORNERS.
 - 8. PITCH CONSISTENCY NOT TO EXCEED ±.005 WHEN THE OAL OF 5 STRIPS, 20 TABS LONG ARE MEASURED.
 - 9. CAMBER NOT TO EXCEED .060, TWIST NOT TO EXCEED 18° OVER 18 INCHES.
 - 10. ALL PARTS MUST BE FREE OF CONTAMINANTS (GREASE, OILS, ETC.), AND/OR IMPERFECTIONS THAT COULD AFFECT THE FORM, FIT, OR FUNCTION.
 - 11. QUANTITY OF PARTS PER REEL: 17,000. ONE BREAK NOT LESS THAN 25% OF REEL CAPACITY AND NO SPLICES ALLOWED WITHIN A REEL.
- RECOMMENDED GOLD PCB HOLE SIZE: DRILL Ø .052 ± .001
 COPPER PLATED: Ø .048 ± .002
 FINISHED HOLE: Ø (.047) REF

REV	REVISION RECORD	ECN	BY	APVD	DATE
X1	PROPOSAL PER EWR 107175	-	RJB	RJB	04/11/11
X2	CHANGE OF REELING DIRECTION	-	RJB	RJB	05/19/11
X3	BLADE COIN TIP DIM CHANGE	-	RJB	RJB	08/19/11
A	RELEASE PER EWR 107175	506304	RJB	RJB	08/22/11

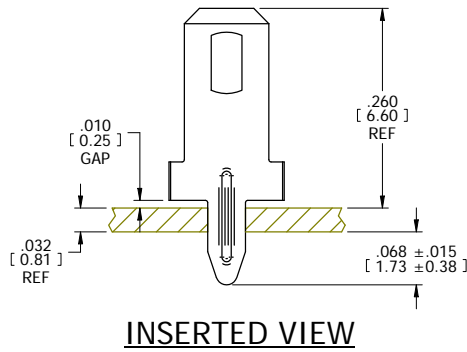

INSERTED VIEW

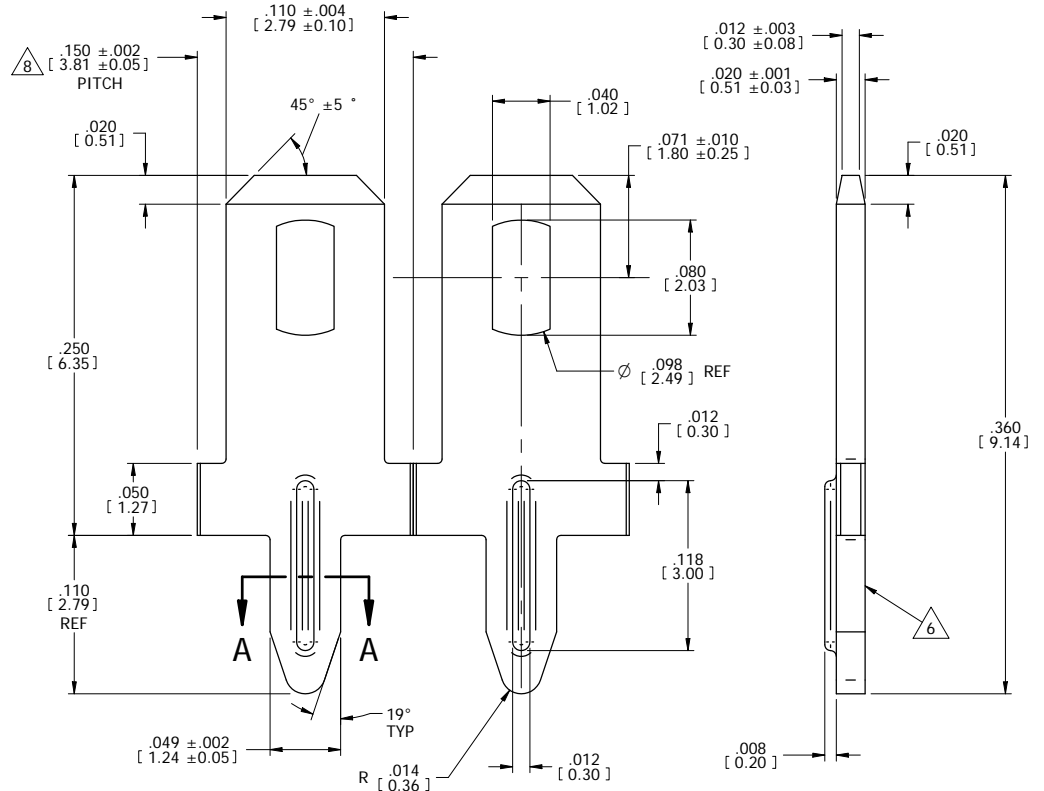

INSPECT W/ RING GAUGE
.0520 ± .0015
[1.32 ± 0.04]

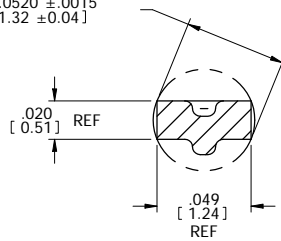

SECTION A-A

11 REELING ORIENTATION AFTER PLATING

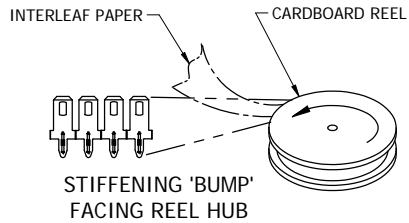

CONFIDENTIAL
CUSTOMER DRAWING

The drawing and the information set forth hereon are the property of AutosplICE, Inc. and are to be held in trust and confidence. Publication, disclosure, or use for any purpose not expressly authorizing in writing by AutosplICE, Inc. is prohibited.

MATERIAL:	2
FINISH:	3

TOLERANCES UNLESS OTHERWISE SPECIFIED DIMENSIONS IN INCHES	DECIMAL: .XX = ± .01 [XX] = ± [0.3] XXX = ± .005 [XXX] = ± [0.13]	ANGULAR: ± 3°	DIAMOND DENOTES SPECIAL CHARACTERISTIC												
<table border="1"> <tr> <td colspan="2">autosplICE®</td> <td colspan="2">AutosplICE, Inc. 10121 Barnes Canyon Rd. San Diego, CA 92121-2725 858.535.0077</td> </tr> <tr> <td>DESIGNED BY</td> <td>Badger</td> <td>DATE</td> <td>3/29/11</td> </tr> <tr> <td>ENGINEERED BY</td> <td>Badger</td> <td>REVISION</td> <td>3/29/11</td> </tr> </table>				autosplICE®		AutosplICE, Inc. 10121 Barnes Canyon Rd. San Diego, CA 92121-2725 858.535.0077		DESIGNED BY	Badger	DATE	3/29/11	ENGINEERED BY	Badger	REVISION	3/29/11
autosplICE®		AutosplICE, Inc. 10121 Barnes Canyon Rd. San Diego, CA 92121-2725 858.535.0077													
DESIGNED BY	Badger	DATE	3/29/11												
ENGINEERED BY	Badger	REVISION	3/29/11												
TITLE: .110 [2.80] VERTICAL TAB															
SIZE: C	FORM NO: OAE89	DRAWING NUMBER: C7-V1111-002TT	REVISION: A												
SCALE: 8:1 P&O NO: C7-V1111-002TT PART MODEL NO: 7-V1101-002 part SHEET 1 OF 1															

4

3

2

1