

4

3

2

1

NOTES: UNLESS OTHERWISE SPECIFIED

- 1. INTERPRET DRAWING IN ACCORDANCE WITH ANSI Y14.5M-1994.
- 2. MATERIAL: C26000 BRASS, 1/2 HARD.
- 3. FINISH: POST-PLATED "AA" = .000120" [0.003] MIN MATTE 90/10 SnPb OVER .000050" [0.00127] MIN NICKEL, "TT" = .000120" [0.003] MIN MATTE Sn OVER .000050" [0.00127] MIN NICKEL.
- 4. ALL DIMENSIONS APPLY AFTER PLATING.
- 5. .003 [0.08] MAX BLANKING BURR PERMISSIBLE, BURRS NOT TO EXCEED THE SPECIFIED FEATURE TOLERANCE.
- 6. .005 [0.13] MAX RADII & FILLETS PERMISSIBLE ON ALL CORNERS.
- 7. QUANTITY OF PARTS PER REEL: 30,000 ±15%, PACKAGE PER AUTOSPLICE SPEC 0049.
- 8. A) RECOMMENDED HASL PTH HOLE SIZE: DRILL: $\phi .048 \pm .001$
Cu HOLE: $\phi .044 \pm .002$
SnPb HOLE: $\phi .043 \pm .003$
- B) RECOMMENDED ENIG PTH HOLE SIZE: DRILL: $\phi .0474 \pm .0010$
Cu HOLE (.0008-.0015" per side): $\phi .046 \pm .002$
Ni HOLE (.000100-.000150" per side): $\phi .045 \pm .002$
Au HOLE (.000004-.000010" per side): $\phi .045 \pm .002$
- C) RECOMMENDED UNPLATED PUNCHED HOLE SIZE: $\phi .044 \pm .002$
- D) RECOMMENDED UNPLATED PUNCHED SLOT SIZE:

PART NUMBER	"X"	"Y"	"Z"	ECN	ITEM REV
7-V1067-002[]	.478 [12.14]	.382 [9.70]	.039 [1.00]	502983	B
7-V1067-012[]	.447 [11.35]	.388 [9.85]	.049 [1.25]	502969	A
7-V1067-022[]	.441 [11.20]	.382 [9.70]	.039 [1.00]	502969	A

REV	REVISION RECORD	ECN	BY	APVD	DATE
A	NEW RELEASE PER EWR 103120	502969	JB	JB	10/22/03
B	CHNG OAL Item 002 to .478	502983	JB	JB	11/3/03
C	ADD ENIG DRILL REC PER EWR 103649	503160	JB	JB	2/17/04

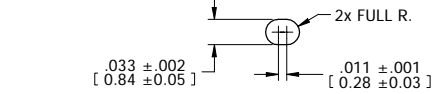

E) RECOMMENDED DOUBLE DRILL HOLE FOR ENIG PLATING:

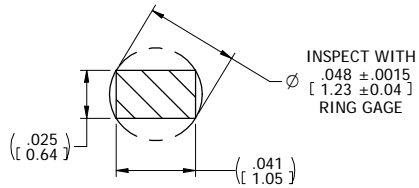
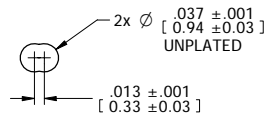

SECTION A-A

7 REELING ORIENTATION

14" CARDBOARD REEL, P/N 52-2339-8 OR EQUIV.

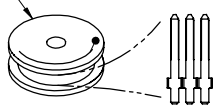

(BURR SIDE FACING HUB)

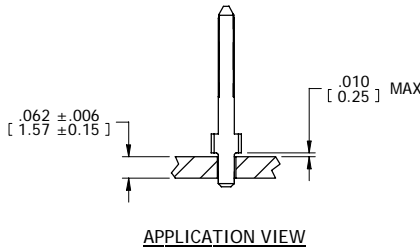

APPLICATION VIEW

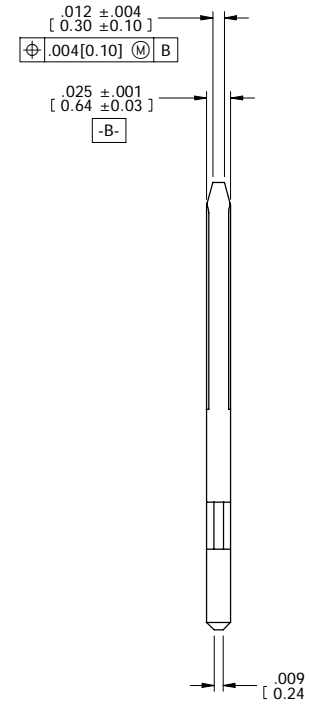
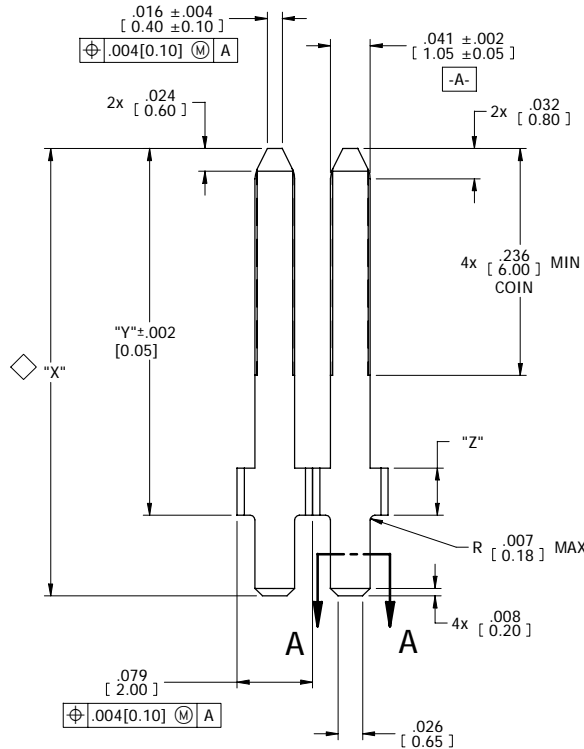

CUSTOMER DRAWING

The drawing and the information set forth hereon are the property of Autosplíce, Inc. and are to be held in trust and confidence. Publication, disclosure, or use for any purpose not expressly authorizing in writing by Autosplíce, Inc. is prohibited.

MATERIAL:	2
FINISH:	3

TOLERANCES UNLESS OTHERWISE SPECIFIED DIMENSIONS IN INCHES (MM)	autosplíce		Autosplíce, Inc. 10121 Barnes Canyon Rd. San Diego, CA 92121-2725 858-535-0077
DECIMAL: .XX = + .01 [X.X] ± [0.3]	THIRD ANGLE PROJECTION	ENGINEER: JOE	DATE: 08-29-02
XXX = .005 [X.XX] ± [0.13]		ENGINEER BY: BIANCA	DATE: 08-29-02
ANGULAR: ° = 2'		TITLE: VERTICAL TERMINAL, 1.05mm	
◇ DENOTES SPECIAL CHARACTERISTIC	SIZE: C	ECN NO: OAE89	DESIGN NUMBER: C7-V1067-0[2][]
	SCALE: 8:1	DWG NO: C7-V1067-0[2][]	ECN: []
		MODEL NO: 7-V1067-0[2] PAIR	SHEET 1 OF 1