

4

3

2

1

NOTES: (UNLESS OTHERWISE SPECIFIED)

1. INTERPRET DRAWING IN ACCORDANCE WITH ASME Y14.5-1994.
2. MATERIAL: BRASS C26000, TEMPER 1/2 HARD, UNPLATED STOCK THICKNESS .0315±.0005.
3. FINISH: POST- PLATE .000200" MIN TIN/LEAD OVER .000080" MIN NICKEL, PER AUTOSPlice SPEC-0001.
4. ALL DIMENSIONS APPLY AFTER PLATING.
5. .004 MAX BLANKING BURR PERMISSIBLE, BURRS NOT TO EXCEED THE SPECIFIED FEATURE TOLERANCE.
6. .005 MAX RADII PERMISSIBLE ON ALL CORNERS.
7. QUANTITY OF PARTS PER REEL: 20,000 ONE BREAK NOT LESS THAN 25% OF REEL CAPACITY AND NO SPLICES ALLOWED WITHIN A REEL. PACKAGE PER AUTOSPlice SPEC-0049.
8. RECOMMENDED DRILLED HOLE SIZE: \varnothing .088±.001 [2.24±0.03]
Cu PLATING: \varnothing .084±.003 [2.13±0.08]
Sn-Pb PLATING: \varnothing .083±.003 [2.11±0.08]

REV	REVISION RECORD	ECN	BY	APVD	DATE
A	INITIAL DESIGN	506733	LD	LD	11/18/13

F

E

D

C

B

A

F

E

D

C

B

A

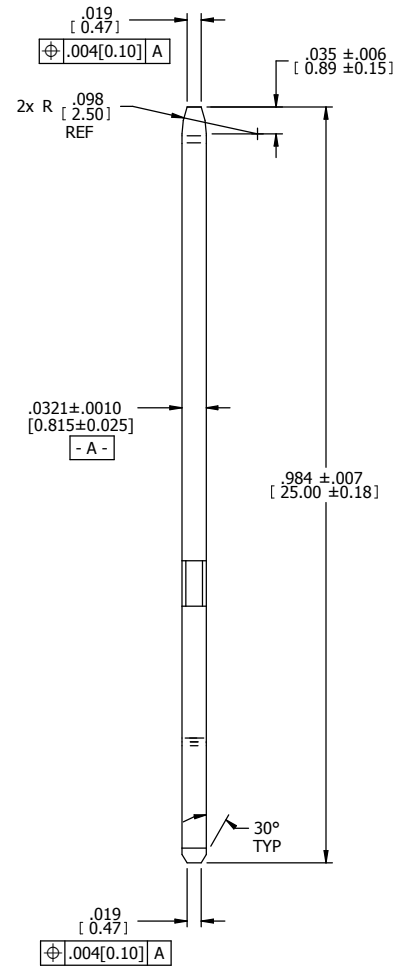
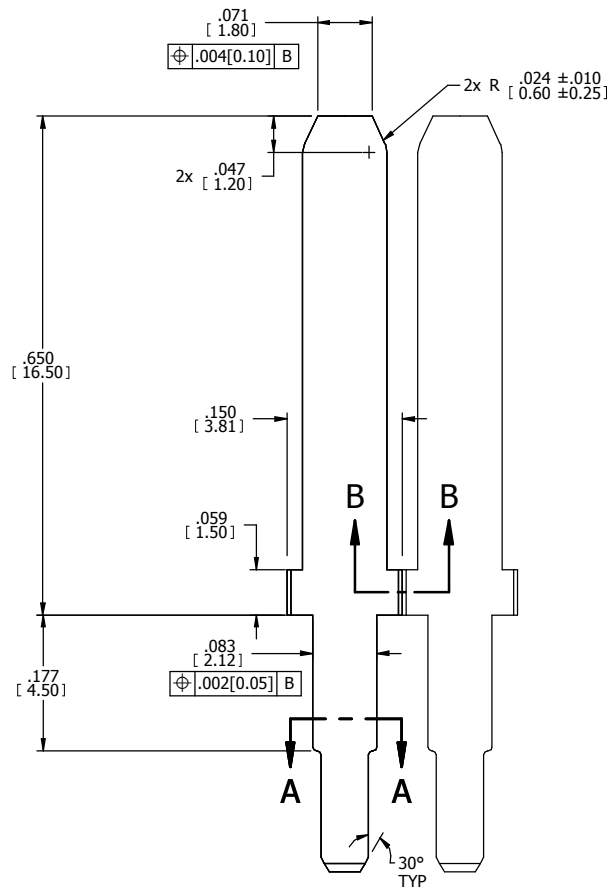
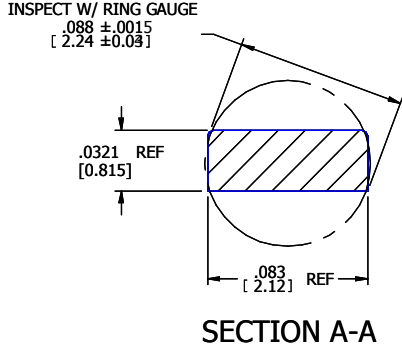
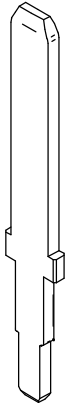

REELING ORIENTATION

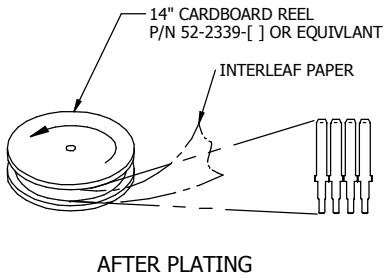

4

3

2

1

**CONFIDENTIAL
PROPOSAL DRAWING**

TOLERANCES UNLESS OTHERWISE SPECIFIED DIMENSIONS IN INCHES (mm)	DECIMAL: .XX = ± .01 [X.X] = ± [0.3] .XXX = ± .005 [X.XX] = ± [0.13]	THRU ANG & PROJECTION 	DRAWN BY: Daenitz ENGINEERED BY: Daenitz DATE: 11/18/13	DATE: 11/18/20
	ANGULAR: ± 5° DENOTES SPECIAL CHARACTERISTIC	TITLE: .110 [2.80] VERTICAL TAB	SIZE: C P/EN NO: OAE89 SCALE: 2:1	DRAWING NUMBER: C7-V1107-002AA A

The drawing and the information set forth herein are the property of Autossplice, Inc. and are to be held in trust and confidence. Publication, disclosure, or use for any purpose not expressly authorizing in writing by Autossplice, Inc. is prohibited.

Autossplice, Inc.
10121 Barnes Canyon Rd.
San Diego, CA 92121-2725
858-535-0077