

NOTES:
1. PART NUMBER BREAKDOWN:

8-256

PIN SIZE .025

6 = SQUARE

ABOVE STAR LENGTH "P"

OVERALL LENGTH "L"

F = .000120 [0.00305]	90/10 TIN/LEAD OVER .000050 [0.0013]	NICKEL
G = .000005 [0.00013]	GOLD OVER .000050 [0.0013]	NICKEL
H = .000010 [0.00025]	GOLD OVER .000050 [0.0013]	NICKEL
J = .000020 [0.00050]	GOLD OVER .000050 [0.0013]	NICKEL
K = .000030 [0.00076]	GOLD OVER .000050 [0.0013]	NICKEL
Y = .000015 [0.00038]	GOLD OVER .000050 [0.0013]	NICKEL

EXAMPLE:

8-256F775515

ABOVE STAR LENGTH .515 [13.08]

OVERALL LENGTH .775 [19.69]

8-256F7751

ABOVE STAR LENGTH .510 [12.95]

OVERALL LENGTH .770 [19.56]

2. RECOMMENDED P.C.B HOLE SIZES:

DRILLED HOLE: $\varnothing .045 \pm .001$ [1.143 ± 0.025]

COPPER PLATING: .001 [0.025] MIN. THICK

TIN-LEAD PLATING: .0003 [0.0076] MIN. THICK

FINISHED HOLE: $\varnothing .040 \pm .003$ [1.016 ± 0.076]

3 PART TO BE SUPPLIED ON A CONTINUOUS REEL AS SHOWN.

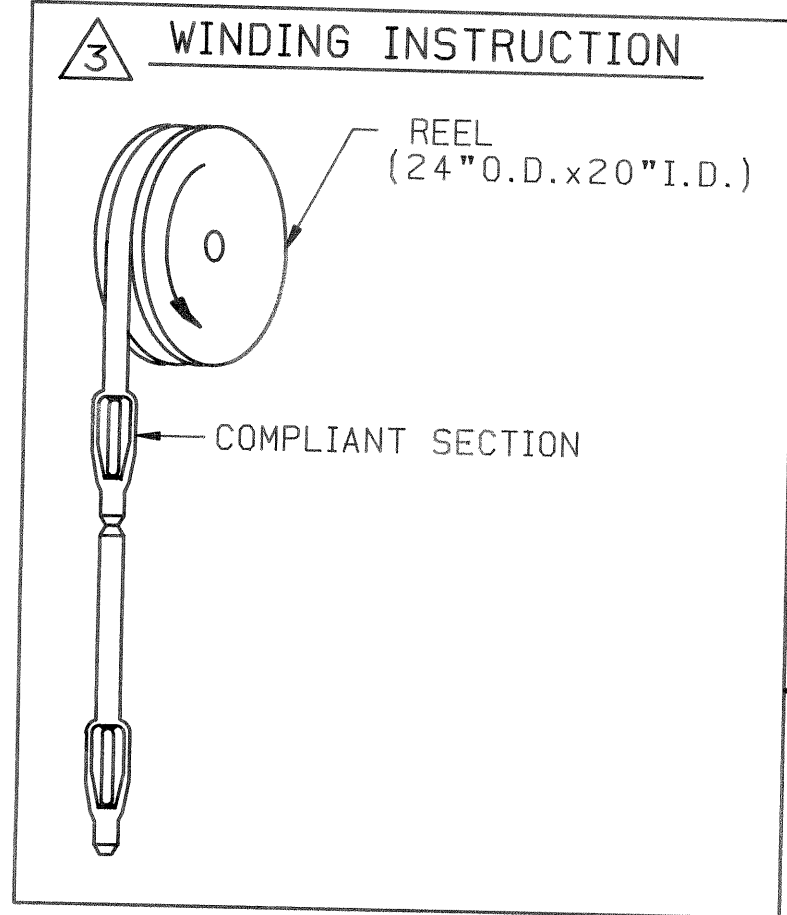
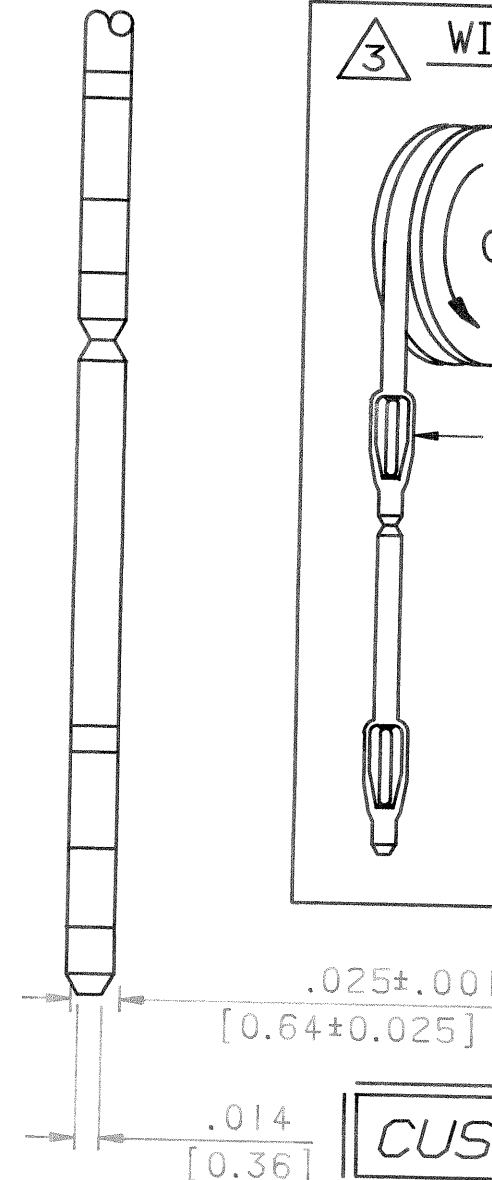
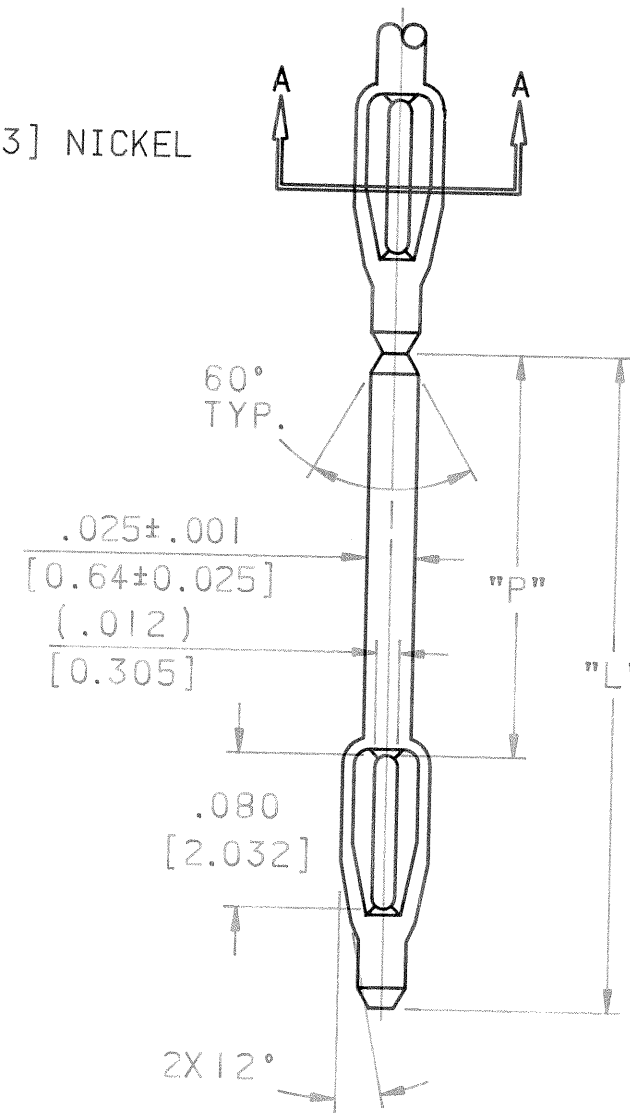
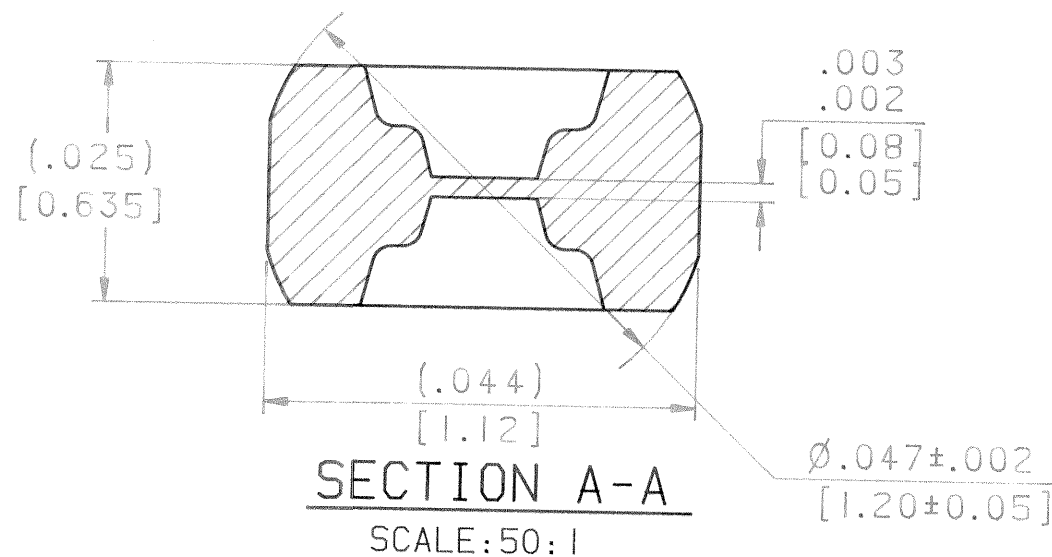

CUSTOMER DRAWING

This drawing and the information set forth hereon are the property of AutosplICE, Inc. and are to be held in trust and confidence. Publication, duplication, disclosure, or use for any purpose not expressly authorized in writing by AutosplICE, Inc. is prohibited.

DATE	SYM	REVISION RECORD	AUTH.	DR.	CK
4-14-94	A	INITIAL RELEASE	12055	WS	

INTERPRET THIS DRAWING IN ACCORDANCE WITH ANSI Y14.5-1982	TOLERANCES (EXCEPT AS NOTED) DIMS IN INCHES [MM]	autosplICE ® AUTOSPLICE INC. 10121 Barnes Canyon Road San Diego, California 92121 (619) 535-0077			
MATERIAL C52100 ALLOY SPECIAL TEMPER	DECIMAL: XX = ±.01 ±[0.25] XXX = ±.005 ±[0.13]	CUSTOMER OR PRODUCT	DRAWN BY W.S.	DATE 5-9-94	APPROVED BY N.C.
FINISH SEE NOTE 1	ANGULAR: ± 3°	TITLE COMPLIANT PIN, .025 SQUARE			
	SIZE B	FSCM NO. 0AE89	DRAWING NUMBER C8-256 <input type="checkbox"/> <input type="checkbox"/> <input type="checkbox"/> <input type="checkbox"/> <input type="checkbox"/> <input type="checkbox"/> <input type="checkbox"/> <input type="checkbox"/>	REVISION A	
	SCALE: 10:1	CAD FILE NO SAME AS DRW NO AND REV.			SHEET 1 OF 1